

HIMACS Shines in Milan with HI MAZE and Nautys

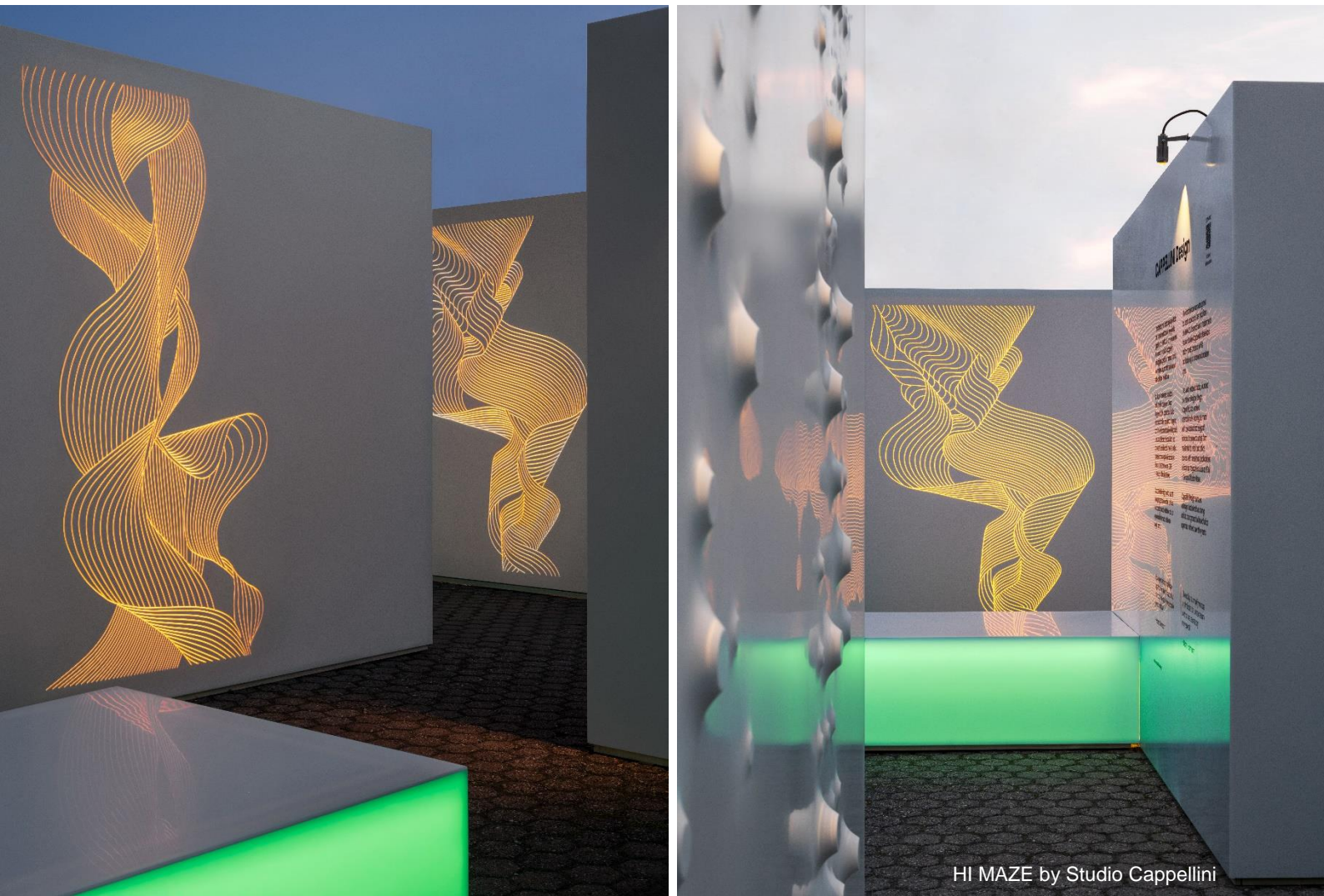

During **Milan Design Week 2025**, HIMACS solid surface took centre stage with **HI MAZE**, an immersive urban installation located in the iconic courtyard of **Fabbrica del Vapore**, which captivated its many visitors. This project was complemented by the launch at the **Tricolore Design Hub** of exciting new outdoor furniture brand **Nautys**, which is also maximises the many benefits of HIMACS. Both presentations highlighted the exceptional design flexibility, aesthetic appeal resilience and durability of this high-performance solid surface material.

HI MAZE: A Landmark Installation of Light, Form and Urban Nature

Set in the outdoor courtyard of Fabbrica del Vapore, **HI MAZE** was an immersive urban labyrinth designed by **Studio Cappellini** and made entirely in HIMACS. Its flowing walls, made from **Alpine White Ultra-Thermoforming**, were sculpted with wave and spiral reliefs through thermoforming and CNC milling, highlighting the material's extraordinary versatility.

Impressive in daylight, the installation truly came into its own after dark. Integrated lighting by **Bespoke Lighting Solutions** transformed HI MAZE into a spectacular visual

HI·MACS

experience, a captivating play of light and shadow that highlighted its sculptural forms and semi-translucent surfaces. By evening, the space evolved into a vibrant, lounge-like setting, actively inhabited by architects, designers and visitors who gathered to unwind, network, and engage with the installation.

Translucent seating in **Sapphire** and **Emerald** from the **HIMACS Lucent** collection introduced depth and playful contrast, while curated greenery by **Gruppo A' Piè** added a touch of nature, striking a thoughtful balance between the organic and the architectural. Guests were also invited to touch, play with and explore a wide selection of HIMACS colour samples, experiencing the material's smooth, tactile surface and extensive design potential first-hand.

Beyond aesthetics, the project also referenced sustainability, featuring SCS-certified recycled content in the Alpine White HIMACS elements, demonstrating how both creativity and responsibility can go hand-in-hand.



HIMACS

HIMACS made a splash with the nautical furniture collection by Nautys

HIMACS was also on show at the "FROM SPACE TO TASTE" event hosted by **Tricolore Design Hub**, where **Nautys**, a new brand focused on outdoor and nautical furniture, presented its first collection. A collaboration between **Lucchesedesign Studio**, **Summit X**, and **Gallinea**, Nautys makes the most of HIMACS' durability, weather resistance and sleek finish.

From seating and tables to lighting elements, each product demonstrates how HIMACS performs in demanding environments while offering clean lines and elegant surfaces. Though initially developed for marine use, the collection is also suited to hospitality, residential, and workplace settings.



HIMACS Media contact for Europe:

Mariana Fredes – Ph. +41 (0) 79 693 46 99 – mfredes@lxhausys.com

High resolution images available: <https://www.lxhausys.com/eu-en/case-studies>

HI·MACS

PROJECT INFORMATION HI MAZE

Project: HI MAZE

Location: Fuorisalone, Fabbrica del Vapore, Milan (Italy)

Design: Studio Cappellini Design | cappellini.design | Instagram @cappellini.design

HIMACS master distributor: Sogimi | www.sogimi.com | Instagram @sogimi_hub

Material: HIMACS S305 Emerald, S303 Sapphire, S928 Alpine White Ultra-Thermoforming with SCS Certified Recycled Content | Website www.lxhausys.com/eu / Instagram @himacseurope

Lighting design: Bespoke Lighting Solutions | www.bespoke-light.com/ Instagram @bespoke_lighting_milano

Greenery project: Gruppo A' Piè

Photography: © Francesco Marano / EllerStudio | Instagram @ellerstudio

PROJECT INFORMATION NAUTYS

Brand: Nautys | nautys.it/

Design: Studio Lucchesedesign | www.francescolucchese.com

Distributor: Summit X | summit-x.com

International Marine Distributor: Gallinea | www.gallinea.it

Material: HIMACS Alpine White S028 | www.lxhausys.com/eu

Photography: © Studio Lucchesedesign

HIMACS Media contact for Europe:

Mariana Fredes – Ph. +41 (0) 79 693 46 99 – mfredes@lxhausys.com
High resolution images available: <https://www.lxhausys.com/eu-en/case-studies>

HIMACS

The shape of your ideas

www.lxhausys.com/eu/himacs

HIMACS is a solid surface material that can be moulded into any shape. It is widely used for architectural and interior applications, such as sculptural and high-performance wall cladding or kitchen, bathroom and furniture surfaces, in commercial, residential and public space projects. It is composed of minerals, acrylic and natural pigments that come together to provide a smooth, non-porous and visually seamless surface which meets the highest standards for quality, aesthetics, fabrication, functionality and hygiene – offering many advantages over conventional materials.

HIMACS provides limitless possibilities for surfacing solutions and inspires creative minds from all over the world. **Zaha Hadid, Jean Nouvel, Rafael Moneo, Karim Rashid, Marcel Wanders** and **David Chipperfield**, among others, have completed fabulous projects using HIMACS.

Proud to be at the forefront of innovation, LX Hausys made Solid Surface history with the introduction of **HIMACS Ultra-Thermoforming**, a pioneering formulation which pushes the boundaries of solid surface shaping to significant new levels with 30% greater thermoplastic capability. Furthermore, **HIMACS Intense Ultra** is a groundbreaking advance that now combines the qualities of both **Intense Colour Technology** and **Ultra-Thermoforming**.

To add to the benefits of working with HIMACS, now the iconic HIMACS Alpine White, plus a wide selection of colours, come with SCS certified pre-consumer recycled content for a more sustainable product offering.

HIMACS uses a simple heating process to give three-dimensional thermoplastic forming capabilities, allows visually seamless designs, offers a virtually limitless range of colours and – for some shades – exhibits a special translucency when exposed to light. Although HIMACS is almost as robust as stone, it can be worked in a similar way as wood: it can be sawn, routed, drilled or sanded.

HIMACS is made using a next-generation technology, the **thermal cure**. The temperature reached during the manufacturing process sets HIMACS apart from other solid surfaces and creates a denser surface that is even sturdier, more homogeneous and more durable, and with better resistance and superior thermoforming results.

HIMACS does not absorb humidity, is highly resistant to stains and is easy to clean, maintain and repair. HIMACS is composed from premium-quality materials, ensuring a surface that is free from harmful substances such as silica, formaldehyde, VOC emissions, and nanoparticles. Prioritising health and safety, HIMACS offers peace of mind for any environment.

Countless internationally recognised certificates attest to the quality of HIMACS in terms of ecological commitment, hygiene and fire resistance – being the first Solid Surface in the market to receive the official **European Technical Approval (ETA) for façades** – for the Alpine White S728 colour.

HIMACS offers a 15-year warranty for products fabricated by a Quality Club Member.

For more information and to stay connected, visit our [EU WEBSITE](#), [UK WEBSITE](#) and our [newsroom](#).

Let's connect!



HIMACS media contact for Europe:

Mariana Fredes – Ph. +41 (0) 79 693 46 99 – mfredes@lxhausys.com
High resolution images available: <https://www.lxhausys.com/eu-en/case-studies>

HI·MACS

HIMACS is designed and produced by **LX Hausys (formerly LG Hausys)**, a world leader in the technology sector and a subsidiary of LX Holdings Corp.

HIMACS Media contact for Europe:

Mariana Fredes – Ph. +41 (0) 79 693 46 99 – mfredes@lxhausys.com

High resolution images available: <https://www.lxhausys.com/eu-en/case-studies>