

Milan Design Week 2025

## HI MAZE, a labyrinth in urban greenery

An installation in HIMACS designed  
by Studio Cappellini Design at the Fabbrica del Vapore  
Milan Design Week | 8-13 April 2025

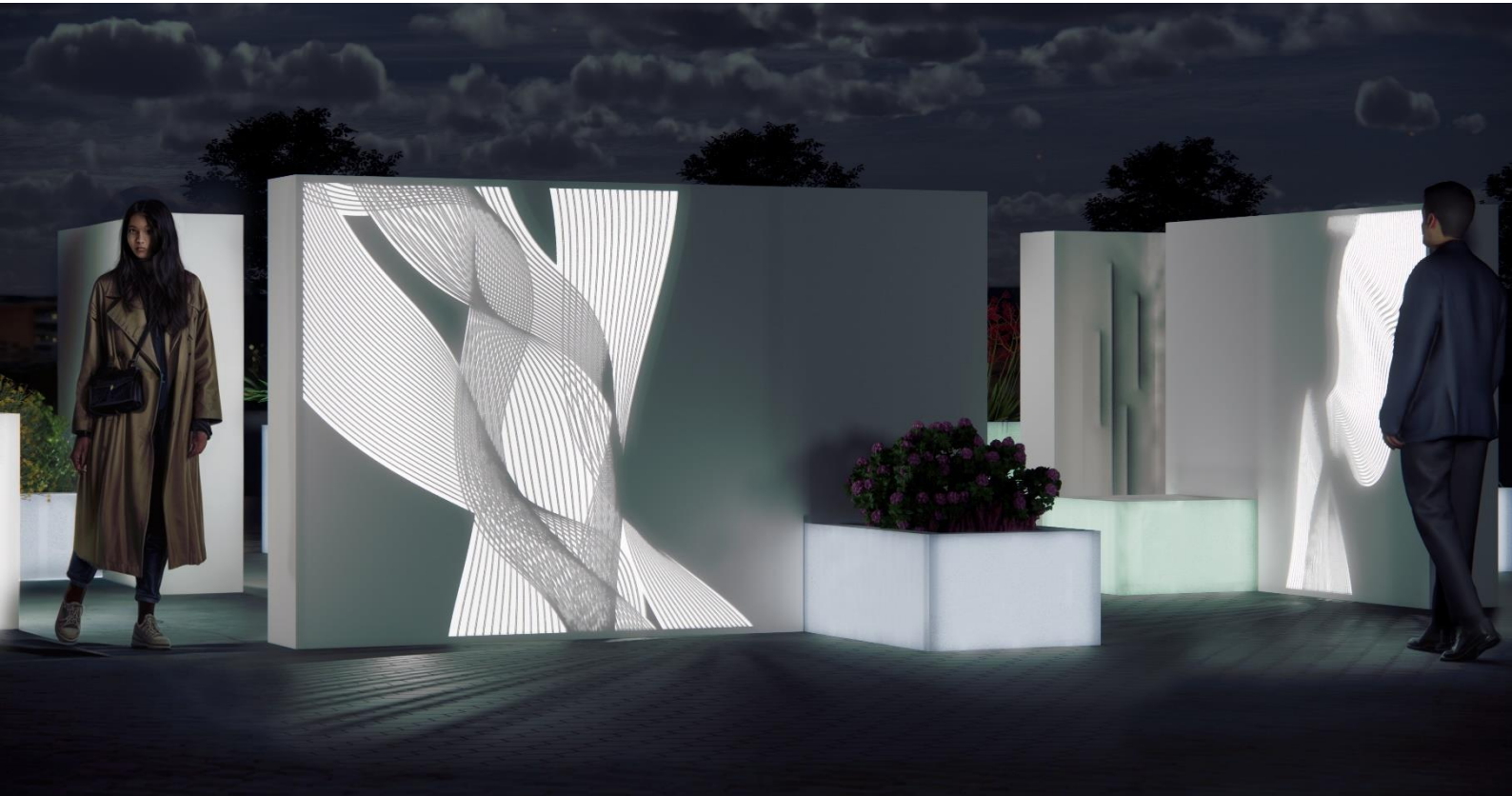

**HI MAZE** is an immersive installation conceived by Studio Cappellini Design and made entirely of HIMACS solid surface. From April 8 to 13, 2025 — during the always highly anticipated Milan Design Week, which attracts visitors from around the world— the 'urban labyrinth' will be open to the public in the outdoor space of the Fabbrica del Vapore.

**HI MAZE** investigates the relationship between humanity and contemporary design, reinterpreting the aesthetics of the labyrinth and transforming it from a symbol of bewilderment and complexity into an immersive, exploratory experience. Innovative materials, light, colour, greenery and space are all intertwined here in elegant harmony.

The installation consists of a series of wall blocks and seats made of **HIMACS** — inviting visitors to pause and interact — thoughtfully arranged to guide them through a dynamic pathway, punctuated by strategic openings and captivating plays of light. The result is a

HIMACS Media contact for Europe:

Mariana Fredes – Ph. +41 (0) 79 693 46 99 – [mfredes@lxhausys.com](mailto:mfredes@lxhausys.com)

High resolution images available: <https://www.lxhausys.com/eu-en/case-studies>

# HI·MACS

harmonious dialogue between **matter, form and perception**, in which the various levels of the monoliths evoke an urban landscape in miniature and a stripped-back **skyline** reduced to its purest forms.

**HI MAZE** sets out to explore the material and its potential, highlighting the extraordinary aesthetic and functional qualities of **HIMACS**, processed using advanced **thermoforming and CNC** techniques by **Luxu Design** for **IDC**. The walls tracing the labyrinthine path make use of the **Alpine White Ultra-Thermoforming** shade, an ideal choice for the application of relief motifs such as waves, spirals and elaborate textures, milled into the surfaces and enriched with evocative lighting.

This choice not only enhances the labyrinth's design but also underscores a commitment to increased sustainability: **HIMACS Alpine White Ultra-Thermoforming** is made with **8% SCS-certified recycled content**.

The seats and planters along the route are also made from **HIMACS**, here offered in the delicate pastel shades of **Emerald** and **Sapphire** from the **HIMACS Lucent** collection. With their unique translucency, these colours interact beautifully with strategic lighting, turning surfaces into immersive, visually striking elements.

Curated by Bespoke Lighting Solutions, the lighting design brings to life a light installation that evokes the allure of cities seen at night: the skillful use of illumination and the workmanship of the HIMACS panels amplify the depth of the space, making the experience even more immersive. In addition, A' Piè Group's contribution to the design of the greenery underscores HIMACS' commitment to a more environmentally conscious design, in tune with nature and the recycled aspect of the material itself.

**HIMACS** is an extremely versatile material designed to ensure optimal use in any context. Its distinctive characteristics meet the most sophisticated needs of architects and designers, thanks to a robustness akin to natural stone and an extraordinary formability allowing almost any desired shape to be achieved. These qualities are complemented by exceptional durability, high standards of hygiene and superior resistance to fire and water.

## **PROJECT INFORMATION**

**Project:** HI MAZE

**Location:** Fuorisalone, Fabbrica del Vapore, via Giulio Cesare Procaccini 4 | Milan (Italy)

**Architectural firm:** Studio Cappellini Design | Website <https://cappellini.design/> Instagram [cappellini.design](https://www.instagram.com/cappellini.design)

**HIMACS transformer:** Luxu Design for IDC | Website <https://italiandesigncorporation.it/> - [www.luxudesign.net](http://www.luxudesign.net) - Instagram [luxu\\_design](https://www.instagram.com/luxu_design)

HIMACS master distributor: Sogimi | Web site [www.sogimi.com](http://www.sogimi.com)

HIMACS Media contact for Europe:

Mariana Fredes – Ph. +41 (0) 79 693 46 99 – [mfredes@lxhausys.com](mailto:mfredes@lxhausys.com)

High resolution images available: <https://www.lxhausys.com/eu-en/case-studies>

# HI·MACS

**Material:** HIMACS S305 Emerald, S303 Sapphire, S928 Alpine White Ultra-Thermoforming with SCS Recycled Content | Website [www.lxhausys.com/eu/](http://www.lxhausys.com/eu/) | Instagram [@himacseurope](https://www.instagram.com/himacseurope)

**Lighting design:** Bespoke Lighting Solutions | Website <https://www.bespoke-light.com/> | Instagram [bespoke\\_lighting\\_milano](https://www.instagram.com/bespoke_lighting_milano)

**Greenery project:** Gruppo A' Piè

**Render:** Studio Cappellini Design

## **PARTNER INFORMATION**

### **DIEGO CAPPELLINI**

Interior designer trained at the Academy of Fine Arts. Over the course of a 23-year career, he has worked around the world, leaving his mark with interiors that are conceptual, yet refined. His pursuit of a 'way of life' rooted more in emotion than in ostentation has shaped a design approach that merges an artistic background with a technical expertise honed over the years — enriched by collaborations with lighting and systems consultants such as Pollice Illuminazione, Bespoke Lighting Solutions, and engineer Andrea Rotta. He works in partnership with architect Tomaso Musicco, with whom he founded the CMAD ('Cappellini Musicco Architecture Design') Studio in 2014, as well as independently through Studio Cappellini Design, alongside collaborators Jeidyn Bautro, Laura Schofield, and Flavio Serpino.

### **CAPPELLINI Design**



Website <https://cappellini.design/>

### **IDC - Italian Design Corporation**

IDC represents the excellence of Italian craftsmanship, managing the entire construction process right through to the installation of the furniture. Specialising in custom-made furniture, kitchens and high-quality lighting, they collaborate with the very best Italian brands. They offer both catalogue and customised solutions, optimising budget and timing. They work with architects and interior designers to realise exclusive projects. With global experience in turnkey projects, IDC combines innovation and design excellence to create unique and functional spaces.

Website <https://italiandesigncorporation.it/>

### **LUXU DESIGN**

LUXU DESIGN represents a convergence of precision manufacturing and visionary designs. Central to the company's philosophy is the belief that the fusion of craftsmanship and ingenuity has the power to shape a future marked by innovation. In their cutting-edge workshops, raw materials are brought to life, transformed into meticulous creations that reflect their dedication to quality. Each piece made is not just an object; it is a narrative of art, precision and dedication.

Website [www.luxudesign.net](http://www.luxudesign.net)

HIMACS Media contact for Europe:

Mariana Fredes – Ph. +41 (0) 79 693 46 99 – [mfredes@lxhausys.com](mailto:mfredes@lxhausys.com)

High resolution images available: <https://www.lxhausys.com/eu-en/case-studies>

# HIMACS

## BESPOKE LIGHTING SOLUTIONS

Bespoke Lighting Milano was born from a passion for light, distinguishing itself on the market for its ability to fuse excellent craftsmanship, technological innovation and design sensitivity. Specialising in custom lighting solutions, the company operates across the luxury interior design, office and hospitality markets. Each intervention is an opportunity for research where light is interpreted as a living element, capable of shaping environments and evoking emotions.

Website <https://www.bespoke-light.com/>

## SOGIMI

The Sogimi Group is the ideal partner for designers, enterprises and companies, offering a complete range of materials from the very best international brands dedicated to interior design.

Driven by innovation, the Group has earned its place as a trailblazer in the industry, offering solutions that are always ahead of the curve. Sogimi's far-reaching presence across Italy ensures they're always close at hand, delivering expert advice and timely support to their clients.

As a Master Distributor for HIMACS in Italy, Sogimi's commitment focuses on sustainable and environmentally friendly materials combined with exclusive consultancy, design support and customised machining services to accompany customers at every stage of the project.



Website [www.sogimi.com](http://www.sogimi.com)

HIMACS Media contact for Europe:

Mariana Fredes – Ph. +41 (0) 79 693 46 99 – [mfredes@lxhausys.com](mailto:mfredes@lxhausys.com)

High resolution images available: <https://www.lxhausys.com/eu-en/case-studies>

## HIMACS

The shape of your ideas

[www.lxhausys.com/eu/himacs](http://www.lxhausys.com/eu/himacs)

HIMACS is a solid surface material that can be moulded into any shape. It is widely used for architectural and interior applications, such as sculptural and high-performance wall cladding or kitchen, bathroom and furniture surfaces, in commercial, residential and public space projects. It is composed of minerals, acrylic and natural pigments that come together to provide a smooth, non-porous and visually seamless surface which meets the highest standards for quality, aesthetics, fabrication, functionality and hygiene – offering many advantages over conventional materials.

HIMACS provides limitless possibilities for surfacing solutions and inspires creative minds from all over the world. **Zaha Hadid, Jean Nouvel, Rafael Moneo, Karim Rashid, Marcel Wanders** and **David Chipperfield**, among others, have completed fabulous projects using HIMACS.

Proud to be at the forefront of innovation, LX Hausys made Solid Surface history with the introduction of **HIMACS Ultra-Thermoforming**, a pioneering formulation which pushes the boundaries of solid surface shaping to significant new levels with 30% greater thermoplastic capability. Furthermore, **HIMACS Intense Ultra** is a groundbreaking advance that now combines the qualities of both **Intense Colour Technology** and **Ultra-Thermoforming**.

To add to the benefits of working with HIMACS, now the iconic HIMACS Alpine White, plus a wide selection of colours, come with SCS certified pre-consumer recycled content for a more sustainable product offering.

HIMACS uses a simple heating process to give three-dimensional thermoplastic forming capabilities, allows visually seamless designs, offers a virtually limitless range of colours and – for some shades – exhibits a special translucency when exposed to light. Although HIMACS is almost as robust as stone, it can be worked in a similar way as wood: it can be sawn, routed, drilled or sanded.

HIMACS is made using a next-generation technology, the **thermal cure**. The temperature reached during the manufacturing process sets HIMACS apart from other solid surfaces and creates a denser surface that is even sturdier, more homogeneous and more durable, and with better resistance and superior thermoforming results.

HIMACS does not absorb humidity, is highly resistant to stains and is easy to clean, maintain and repair. HIMACS is composed from premium-quality materials, ensuring a surface that is free from harmful substances such as silica, formaldehyde, VOC emissions, and nanoparticles. Prioritising health and safety, HIMACS offers peace of mind for any environment.

Countless internationally recognised certificates attest to the quality of HIMACS in terms of ecological commitment, hygiene and fire resistance – being the first Solid Surface in the market to receive the official **European Technical Approval (ETA) for façades** – for the Alpine White S728 colour.

HIMACS offers a 15-year warranty for products fabricated by a Quality Club Member.

For more information and to stay connected, visit our [EU WEBSITE](#), [UK WEBSITE](#) and our [newsroom](#).

*Let's connect!*



**HIMACS** is designed and produced by **LX Hausys (formerly LG Hausys)**, a world leader in the technology sector and a subsidiary of LX Holdings Corp.

HIMACS Media contact for Europe:

Mariana Fredes – Ph. +41 (0) 79 693 46 99 – [mfredes@lxhausys.com](mailto:mfredes@lxhausys.com)

High resolution images available: <https://www.lxhausys.com/eu-en/case-studies>